



These diaphragm pressure switches are IP 55, and suitable for a variety of applications such as: food industry, cannery, pharmaceutical, petrochemical, conventional and nuclear power station. They withstand the most unfavourable working conditions, caused by either the process fluid aggressiveness or high ambient temperature.

3.25 - Standard Model

Ranges: 0...40 mbar / 0...600 mbar.

Electrical specifications: N. 1 SPDT microswitches. (see microswitches table)

Differential: fixed.

Ripeatability: $\leq 1\%$ of the full setting value.

Set point adjustment: internal, micrometric adjustable.

Protection: IP 55 as per IEC 529, UNI 8896.

Electrical wiring: terminal screw, directly on microswitch.

Earth contacts: N. 1 internal, N. 1 external.

Process temperature: +212°F max (100°C).

Ambient temperature: -13...+149°F (-25...+65 °C).

Thermal drift: $\leq 0,027\%$ / °F ($\leq 0,05\%$ / °C).

Process connection: AISI 316 st.st.

Elastic element: AISI 316 st.st. diaphragm.

Gasket: PTFE

Case: aluminium, blue polyurethane painted.

Cover: aluminium, beige polyurethane painted.

Tag: stainless steel, silk-screen painted.

Weight: 6.61 lbs (3 kg).

Setting range	Test pressure	Differential 1 micro (1)
5...40 mbar	0,5 bar	4 mbar
5...60 mbar	0,5 bar	4 mbar
5...100 mbar	0,5 bar	4 mbar
8...160 mbar	0,5 bar	6 mbar
8...250 mbar	1 bar	6 mbar
15...400 mbar	1 bar	10 mbar
15...600 mbar	1 bar	10 mbar

(1) differential and minimum set-point values for microswitches cod. I, N, S, U are 300% of those shown in table.

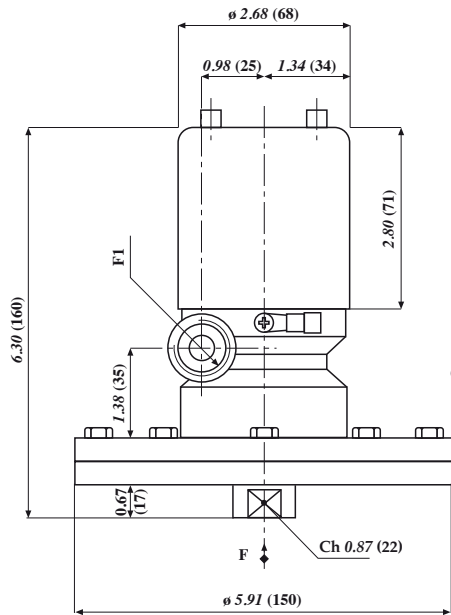

dimensions : inches (mm)

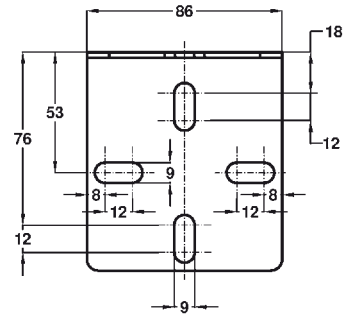
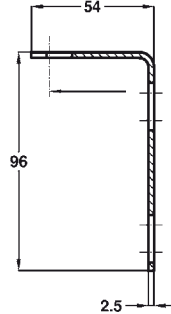

F1	
1	- R 1/2-ISO 7/1
3	- 1/2-14 NPT
P11	- cable gland

F	
43F	- R 1/2-18 NPT F
43M	- 1/2-14 NPT
41M	- G 1/2 B

Set-point adjustment

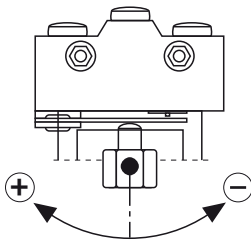

MICROSWITCHES
ohmic load

Single	Type	250	125	24
		Vac	Vac	Vdc
C	std.	15A	15A	0,1A
G	SPLASH	15A	15A	0,1A
I	goldplated		1A	0,1A
M	inert gas filled	15A	15A	0,1A
N	goldplated and inert gas filled		1A	0,1A
S	SPLASH VDC	15A	15A	6A
U	inert gas filled VDC	15A	15A	6A

OPTIONS

P02	- Degreasing for oxygen
S16	- Wall mounting bracket
T01	- Tropicalisation
V20	- Epoxy painting

"HOW TO ORDER" SEQUENCE

Section / Model / Set-point Adjustment / Microswitch / Electrical connection / Process connection / Options					
3	25	C, G	1	41M	P02...V20
		I, M	3	43M	
		N, E	P11	43F	
		S, U			